



Kianda
SCHOOL

KIANDA SCHOOL

SPORTS COMPLEX



INTRODUCTION TO THE INITIATIVE

The Kianda School Sports Complex project is a visionary, parent-led initiative that began with a proposal to improve the Hockey Pitch, evolving into a comprehensive plan for a modern sports complex. This development aligns with the Competency-Based Curriculum (CBC) requirements and aims to support students' holistic growth through improved sports and wellness facilities.

A group of Kianda parents volunteered to support the school in planning and fundraising for this project. They set up 3 committees for this purpose: A Steering Committee to set the project's direction; A Technical Team to work with architects and engineers to plan and design; A Fundraising Team to focus on securing the necessary financial support.

The complex will serve multiple purposes like enhancing student wellness, physical education, and CBC-compliant learning experiences.

This project reflects the school community's commitment to excellence and holistic development for every Kianda student.



The key objectives include:

CBC Compliance

The CBC curriculum emphasizes physical development, requiring well-equipped facilities to support physical education for all students.

01

Comprehensive Sports Facilities:

The complex provides various athletic facilities to nurture students' talents across sports.

02

Community Building

This project strengthens collaboration between parents, alumni, and school administration, creating a legacy for future students.

03



PROJECT VISION

BUILDING LEADERS OF TOMORROW



Contributing to our initiative means fostering well-confident young women who are equipped to make a positive impact. Your involvement helps cultivate future leaders who are ready to face global challenges.

WHY A SPORTS COMPLEX?

Holistic Development

We believe in the importance of a well-rounded education and sports play a crucial role in developing your daughter's physical, mental, and emotional health.

Character Building

Participation in sports instills values like teamwork, perseverance, and leadership.

Improved Academic Performance

Studies have shown that involvement in sports can positively impact academic achievement.

Community Building

The complex will serve as a hub for the school community, fostering a sense of belonging and camaraderie.



THE NEED FOR THE PROJECT

Growing Demand

The increasing requirements in sports activities, the need for more space, and the changing educational landscape (e.g. Competency-Based Curriculum requirements).



CURRENT LIMITATIONS

These investments in sports infrastructure are crucial. Building and maintaining high-quality facilities, providing adequate training spaces, and investing in specialized equipment can significantly enhance the sports landscape and contribute to the development of our talented athletes.



FEATURES OF THE SPORTS COMPLEX

The project includes renovations to existing facilities and new constructions, forming a complete sports complex that will meet diverse needs. The key features include:

Outdoor Facilities

Hockey Pitch and Running Track:

A synthetic turf hockey field and a 200-meter running track will offer a high-quality surface for students and events.

Basketball Court (Indoor and Outdoor): Includes an indoor basketball court for various events, supporting volleyball, gymnastics, and other sports.

Netball and Volleyball Courts: New netball and volleyball courts will be available and the existing ones resurfaced to meet regulation standards.

Tennis Courts: Two existing tennis courts will be resurfaced and will remain accessible supporting individual and team activities.

Gymnasium Complex

Indoor Facilities: A multisports gymnasium, including areas for badminton, table tennis, aerobics, and martial arts, with a spectator area.

Changing Rooms and Washrooms: High-capacity changing rooms and washrooms designed to accommodate school and visiting teams.

Spectator Seating and Snack Bar: Covered seating areas for up to 1,300 spectators, with an additional snack bar in the gymnasium.

Inclusive Design and Safety Features: Wide access paths, ramps, and other accessibility features to ensure safe, universal access for all students and visitors.

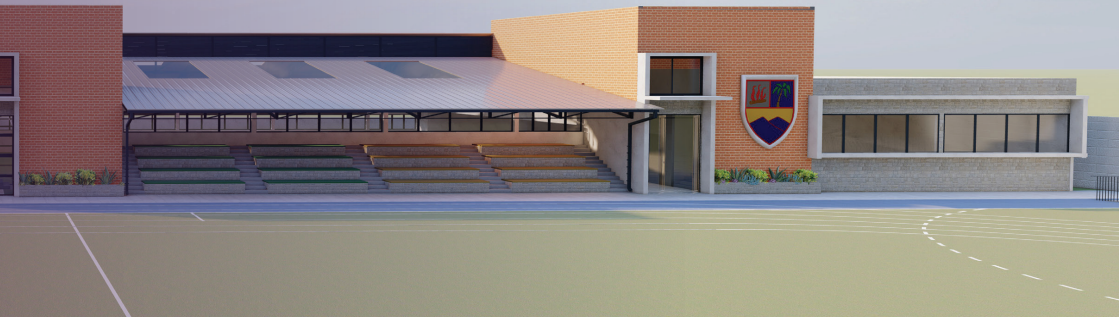

Green Energy and Safety Features

Solar-Powered Lighting and Water Heating: Solar panels will power the lighting, reducing energy costs and environmental impact.

Rainwater Harvesting and Waste Management: A rainwater collection system and waste management practices will ensure sustainable operation and maintenance.

Boundary Wall and Security: New boundary walls with electric fencing and CCTV monitoring will ensure a safe environment for students and staff.



Parental involvement

Parents' involvement is crucial to the success of this initiative.

Fundraising

The Fundraising Committee has developed a multi-faceted approach to meet financial goals.

Corporate sponsorships, parents, alumni & community contributions

- Crowdfunding and Online Giving: A dedicated fundraising platform and online payment gateway will enable direct contributions.
- Sports Tournaments, Auctions, and Raffles: Events will engage the community and create excitement around the project.
- School Fair and Donor Recognition Events: Recognizing donor contributions and hosting events will further incentivize support.
- Grand Fundraising Event: A final event to rally the community and complete funding needs.

We appeal to parents to participate actively by volunteering, spreading awareness, and attending events.

Each class will have two parent representatives to drive engagement and promote the fundraising goals.

How much will the project cost?

The project is estimated to cost about

KES 300,000,000

Part of the cost is broken down into 'blocks'. Each block will be valued at

KES 50,000

How to make your contribution?

You can contribute for the project in the following ways:

- All cheques to be made payable to:
Kianda School Sports Complex
- Deposit funds to the following account;
Bank: Stanbic Bank Kenya Limited
Branch: Waiyaki Way
Account Name: Kianda School
Account Number: 010 001 423 6931
Bank Code: 31000
Swift Code: SBICKENX

Project timeline

- Start Date: Jan 2025
- Completion Date: July 2026

Contact details

Send an email to

accounts@kiandaschool.ac.ke

informing us of the deposit.

